



VX-501

Features

- Surface Mount FR4 based package
- Reflow Process Compatible
- Low Phase Noise and Jitter
- Tight Stabilities
- Frequency Range 10 - 1200MHz
- Standard Frequencies 10; 16,384; 30,72; 32,768; 38,88; 44.8; 52; 61.44; 68.736; 76.8; 77.76; 81.92; 92.16; 100; 112; 122.88; 125; 134.4; 153.6; 155.52; 160; 179.2; 184.32; 195; 208; 245.76; 320; 368.64; 400; 448; 471.8592; 491.52; 622.08; 640
- 672; 737.28; 800; 832; 1000; 1040; 1200.1MHz
- Previous Model Number: C5310

Applications

- Communication
- Test & Measurement
- Medical
- Military

Performance Specifications

Frequency Stabilities ¹						
Parameter	Min	Typical	Max	Units	Condition ²	
vs. operating temperature range (referenced to +25°C)	-15		+15	ppm	-20 to +70°C	
Initial tolerance	-10		+10	ppm	@V _c =V _s /2 V _s ±5% Load ±10%	
vs. supply voltage change	-3		+3	ppm		
vs. load change	-1		+1	ppm		
vs. aging / 1st Year	-2		+2	ppm		
vs. aging (following years)	-1		+1	ppm		
vs. operating temperature range (referenced to +25°C)	-30		+30	ppm	-40 to +85°C	Options ⁵
Initial tolerance	-15		+15	ppm	@V _c =V _s /2 V _s ±5% Load ±10%	
vs. supply voltage change	-3		+3	ppm		
vs. load change	-2		+2	ppm		
vs. aging / 1st Year	-2		+2	ppm		
vs. aging (following years)	-1		+1	ppm		

Performance Specifications

Supply Voltage (Vs)							
Parameter	Min	Typical	Max	Units	Condition ²		
Supply voltage (standard)	3.135	3.3	3.465	VDC	Options ⁵		
Current consumption			40	mA			@ HCMOS, Sinewave
Current consumption			90	mA			@ PECL, LVDS
Supply voltage	4.75	5	5.25	VDC			
Current consumption			30	mA			@ HCMOS, Sinewave
Current consumption			80	mA			@ PECL, LVDS
RF Output							
Signal	HCMOS				Options ⁵		
Load		15		pF			
Rise and Fall time			5	ns			@ 15 pF 10 to 90%
Duty cycle	40		60	%			@ Vs / 2
Signal	PECL						
Load		50		Ω			
Rise and Fall time			1	ns	20 to 80%		
Duty cycle	45		55	%			
Signal	LVDS				Options ⁵		
Load		100		Ω			
Rise and Fall time			1	ns			10 to 90%
Duty cycle	40		60	%			
Signal	Sinewave						
Load		50		Ω			
Output Power	-3	0	3	dBm			
Frequency Tuning (EFC)							
Tuning Range	±65.0	±90	±200.0	ppm			
Linearity	10 %						
Tuning Slope	Positive						
Control Voltage Range	0 0.5	1.65 2.5	3.3 4.5	VDC VDC	with Vs = 3.3V with Vs = 5V		
Frequency Control Input Impedance	100			kΩ			
Additional Parameters							
Phase Noise		-76 -112 -138 -153 -161 -166		dBc/Hz dBc/Hz dBc/Hz dBc/Hz dBc/Hz dBc/Hz	10 Hz 100 Hz 1 kHz 10 kHz 100 kHz 1 MHz	@100MHz LVCMOS 3.3V	
Jitter		0.049		ps RMS	@ 12kHz .. 20MHz		
Phase Noise		-59 -90 -118 -137 -144		dBc/Hz dBc/Hz dBc/Hz dBc/Hz dBc/Hz	10 Hz 100 Hz 1 kHz 10 kHz 100 kHz	@ 300 MHz LVDS 3.3V	
Jitter		0.1		ps RMS	@ 12kHz .. 20MHz		
Phase Noise		-60 -95 -121 -141 -150		dBc/Hz dBc/Hz dBc/Hz dBc/Hz dBc/Hz	10 Hz 100 Hz 1 kHz 10 kHz 100 kHz	@ 491.52 MHz PECL 3.3V	
Jitter		0.03		ps RMS	@ 12kHz .. 20MHz		

Performance Specifications

Additional Parameters

Subharmonics		-40	dBc	For f > 200 MHz	
Weight		2.0 g			
Processing & Packing	Handling & Processing Note				
Absolute Maximum Ratings					
Supply voltage (Vs)		6.0	V		
Operable Temperature Range	-40	+85	°C		
Storage Temperature Range	-40	+95	°C		

Typical Phase Noise and Jitter

Phase Noise

VX-501 @ 100 MHz LVCMOS

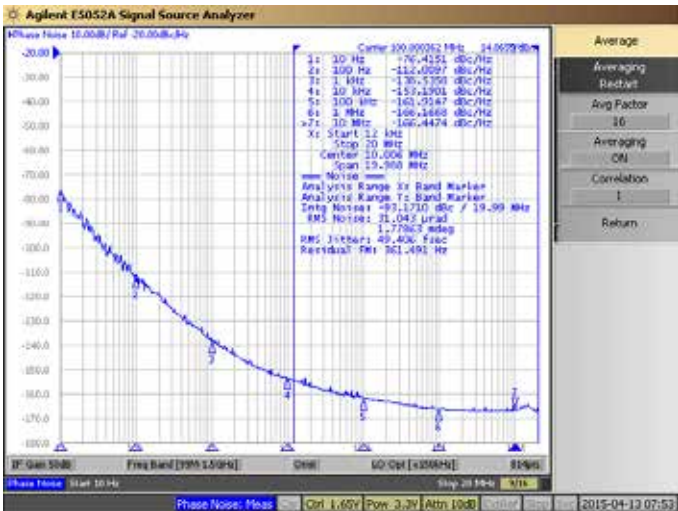

Phase Noise

VX-501 @ 153.6 MHz LVPECL

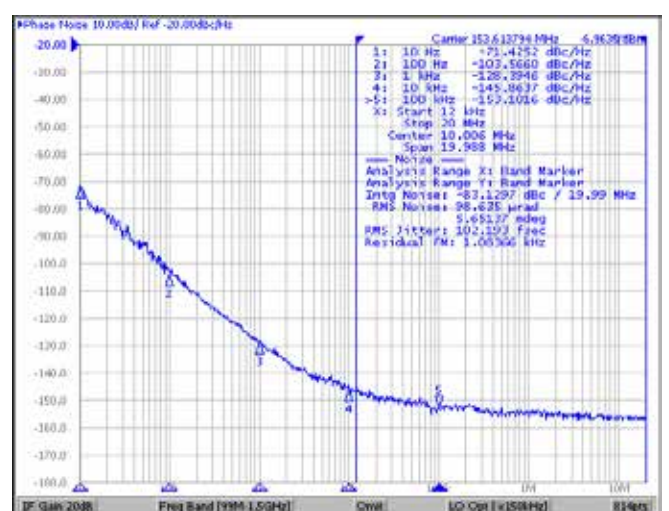

Phase Noise

VX-501 @ 300 MHz LVDS



Phase Noise

VX-501 @ 491.52 MHz LVPECL

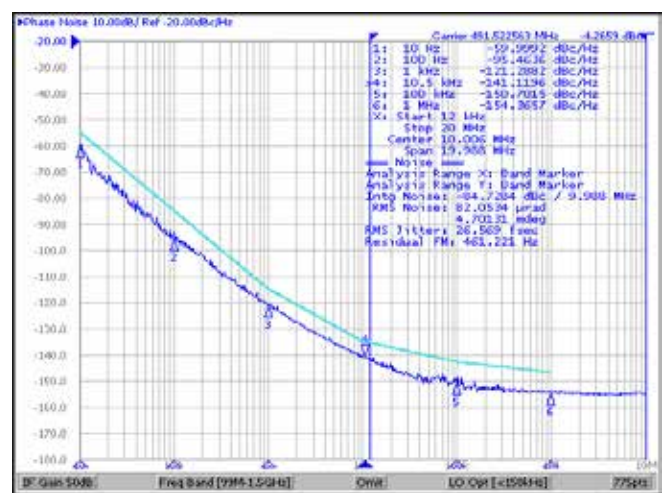

Enclosure

Package Codes	
Type	Height "H"
G223B	5.9

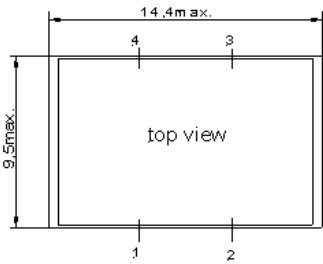

G 223

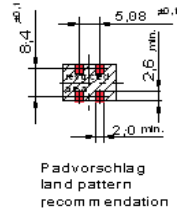
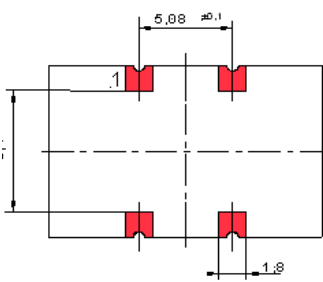
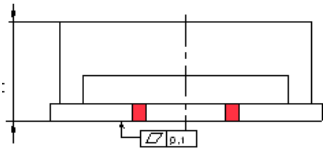

Package Codes	
Type	Height "H"
G218B	5.9
G218E	4.7
G218C	2.8

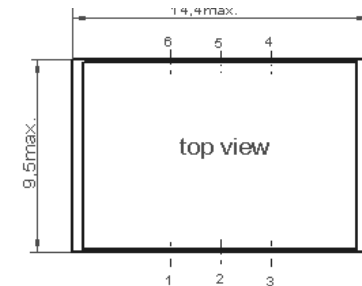

G 218

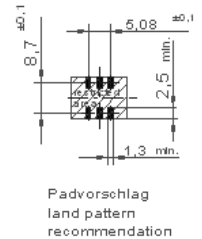
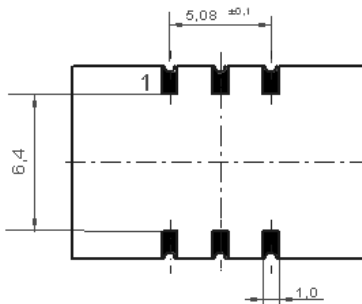
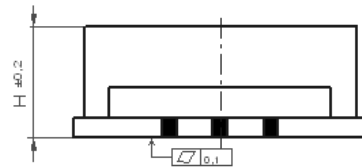

Pin Connections	
1	Control Voltage (Vc)
2	Ground
3	RF Output
4	Supply Voltage Input (Vs)

Pin Connections	
1	Control Voltage (Vc)
2	N.C. / Enable (Option)
3	Ground
4	RF Output
5	RF Output complementary (PECL / LVDS) N.C. (CMOS)
6	Supply Voltage Input (Vs)

Marking
VX-501-xxxx
Frequency
● AYYWW

Enable true table (optional)				
	HCMOS		LVPECL / LVDS	
Pin 2	Pin 4	Pin 5	Pin 4	Pin 5
High	Data	N.C.	No Data	No Data
Open	Data	N.C.	Data	Compl. Data
Low	High Tristate	N.C.	Data	Compl. Data

Standard Shipping Method

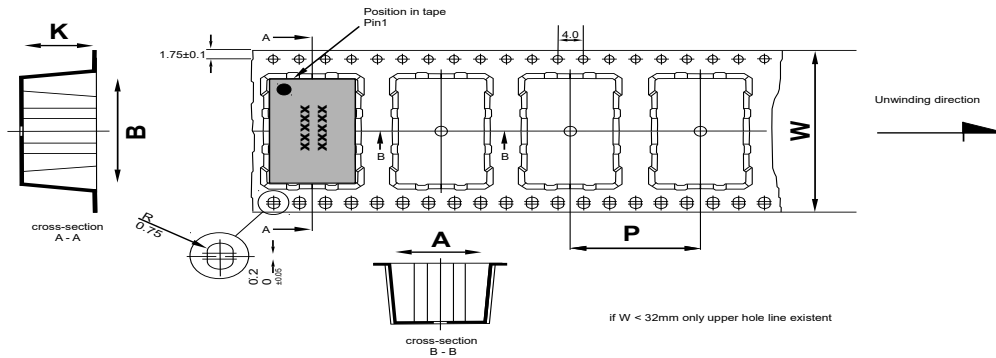

Dimension in mm:
 A, B and K are dependent upon component dimensions
 production tolerance complying DIN IEC 286-3

All dimensions in millimeters unless otherwise stated

Enclosure Type	Tape Width W (mm)	Quantity per meter	Quantity per reel	Dimension P
G218B/G218E/G223B	24	83.3	850	12
G218C	24	83.3	1700	12

Recommended Reflow Profile

TP: max 250°C (@ solder joint, customer board level)

T_p: max: 10...30 sec

Additional Information:

This SMD oscillator has been designed for pick and place reflow soldering

SMD oscillators must be on the top side of the PCB during the reflow process.

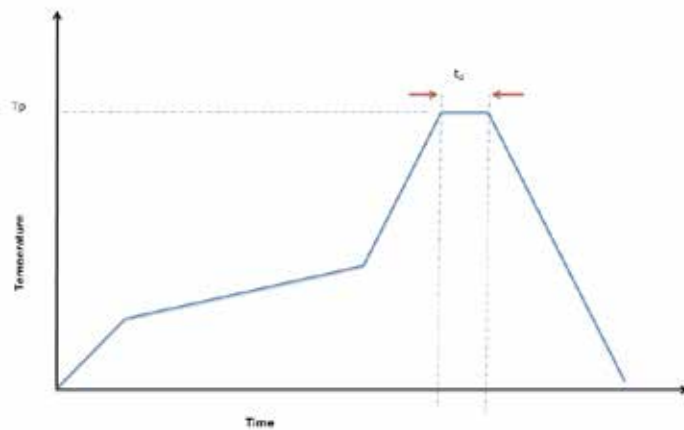

Ordering Information

VX-501 0 - E A J - 105 0 - 122M88

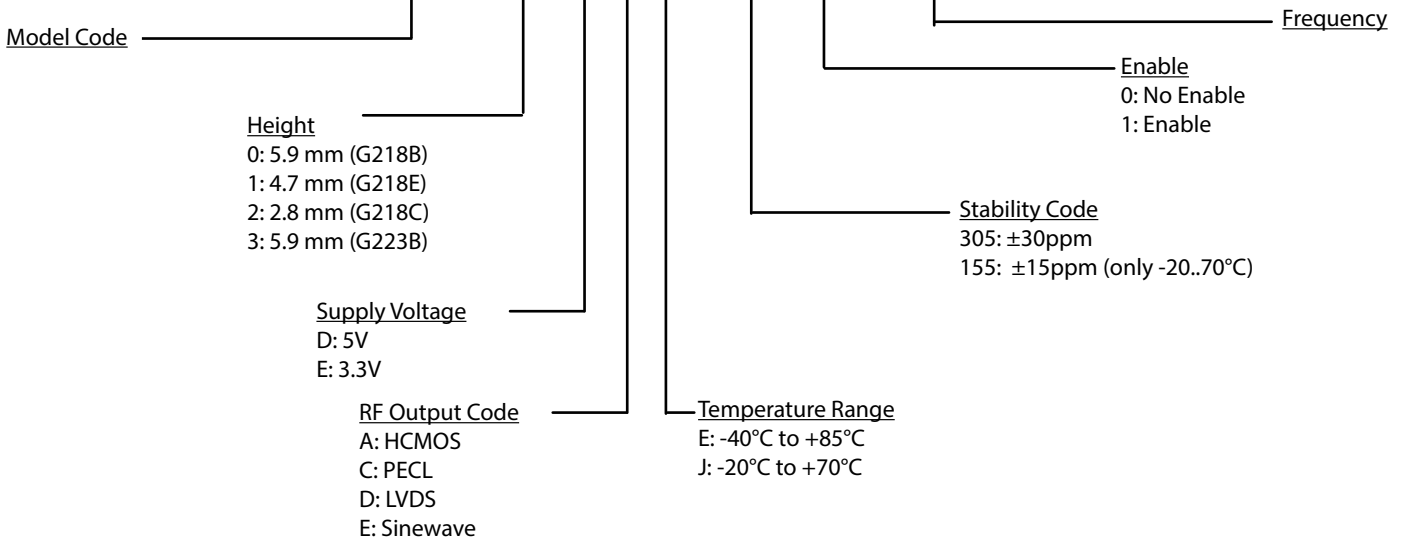

Notes:

1. Contact factory for improved stabilities or additional product options. Not all options and codes are available at all frequencies.
2. Unless other stated all values are valid after warm-up time and refer to typical conditions for supply voltage, frequency control voltage, load, temperature (25°C).
3. Phase noise degrades with increasing output frequency.
4. Subject to technical modification.
5. Contact factory for availability.



Microsemi, a wholly owned subsidiary of Microchip Technology Inc. (Nasdaq: MCHP), offers a comprehensive portfolio of semiconductor and system solutions for aerospace & defense, communications, data center and industrial markets. Products include high-performance and radiation-hardened analog mixed-signal integrated circuits, FPGAs, SoCs and ASICs; power management products; timing and synchronization devices and precise time solutions, setting the world's standard for time; voice processing devices; RF solutions; discrete components; enterprise storage and communication solutions; security technologies and scalable anti-tamper products; Ethernet solutions; Power-over-Ethernet ICs and midspans; as well as custom design capabilities and services. Learn more at www.microsemi.com.

Microsemi Headquarters
 One Enterprise, Aliso Viejo, CA 92656 USA
 Within the USA: +1 (800) 713-4113
 Outside the USA: +1 (949) 380-6100
 Sales: +1 (949) 380-6136
 Fax: +1 (949) 215-4996
 email: sales.support@microsemi.com
www.microsemi.com

Microsemi makes no warranty, representation, or guarantee regarding the information contained herein or the suitability of its products and services for any particular purpose, nor does Microsemi assume any liability whatsoever arising out of the application or use of any product or circuit. The products sold hereunder and any other products sold by Microsemi have been subject to limited testing and should not be used in conjunction with mission-critical equipment or applications. Any performance specifications are believed to be reliable but are not verified, and Buyer must conduct and complete all performance and other testing of the products, alone and together with, or installed in, any end-products. Buyer shall not rely on any data and performance specifications or parameters provided by Microsemi. It is the Buyer's responsibility to independently determine suitability of any products and to test and verify the same. The information provided by Microsemi hereunder is provided "as is, where is" and with all faults, and the entire risk associated with such information is entirely with the Buyer. Microsemi does not grant, explicitly or implicitly, to any party any patent rights, licenses, or any other IP rights, whether with regard to such information itself or anything described by such information. Information provided in this document is proprietary to Microsemi, and Microsemi reserves the right to make any changes to the information in this document or to any products and services at any time without notice.

©2018 Microsemi, a wholly owned subsidiary of Microchip Technology Inc. All rights reserved. Microsemi and the Microsemi logo are registered trademarks of Microsemi Corporation. All other trademarks and service marks are the property of their respective owners.